

TOP VIEW

SPECIFICATIONS

General information

- Panel weight: 35.5kg/m² bare.
- All steel welded construction filled internally with a cementitious core material.
- Protected from corrosion by a powder paint finish.
- Class A flame spread rating.
- Non-combustible material.

UNDERSTRUCTURE OPTIONS

- ☐ Cornerlock

COVERING OPTIONS

- ☐ Bare Painted Finish to accept 3rd party carpet application

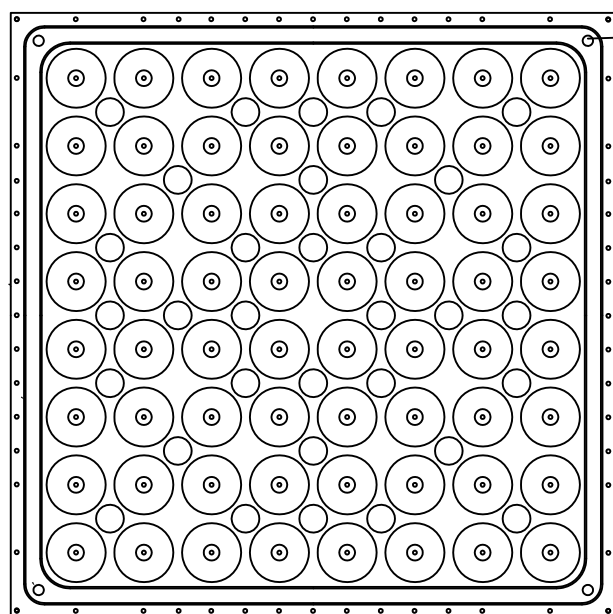

BOTTOM VIEW

Integral shape pocket design and locating tab for positive lateral retention & location with or without screws

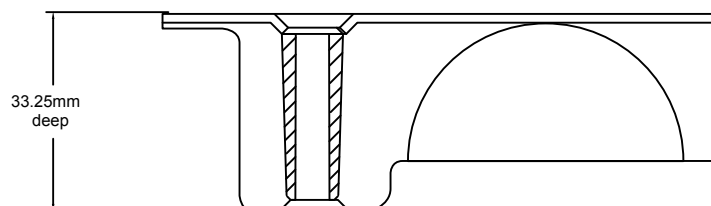

Bare Panel

System Performance Criteria		(Tested on Actual Understructure)*						
System Type	Understructure	SYSTEM WEIGHT	STATIC LOADS			ROLLING LOADS		IMPACT LOADS
Panel			Design Loads	Ultimate Loads	Safety Factor	10 Passes	10,000 Passes	
ConCore® ICSF800-60cm	Cornerlock	38 kg / m ²	3.5kN	Min. 8.8kN	Min. 2.0	2.7kN	1.8kN	0.45kN

1. System Design Load is based on permanent set ≤ 0.010" and is verified by loading panels in accordance with the CISC concentrated load method but with panels installed on actual understructure instead of steel blocks. (Testing on blocks does not represent performance of an actual installation.) Ultimate, Rolling, and Impact Load tests are performed using CISC Test Procedures.

2. Safety factor is Ultimate load divided by Design load.

Tate Asia-Pacific Pty Ltd

Level 12, 100 George Street, Parramatta, NSW, 2150

T: (02) 9612 2300 E: info@tateapac.com W: tateglobal.com

We reserve the right to change specification or design and supply products which may differ from those described and illustrated without notice and without liability. R 11/2025

