

TOP VIEW

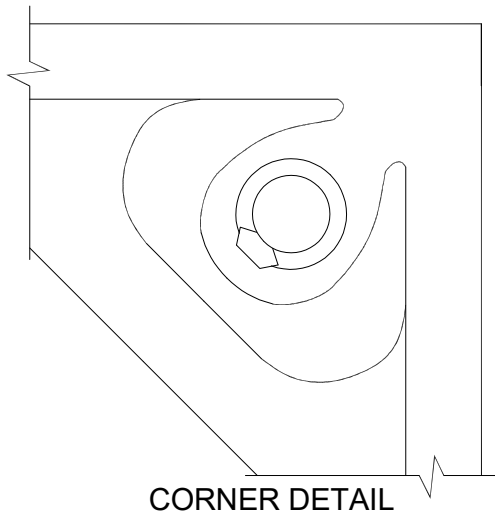

CORNER DETAIL

### SPECIFICATIONS

#### General information (Bare Panel)

- All steel welded construction filled internally with a cementitious core material.
- Protected from corrosion by an epoxy paint finish.
- Class A flame spread rating.

### UNDERSTRUCTURE OPTIONS

- ☐ 4' x .054" Bolted Stringer in a basketweave configuration w/ 8 ga. fillet welded heads
- ☐ 2" Deep x 4' Bolted Stringer in a basketweave configuration w/ 8 ga. fillet welded heads

### COVERING OPTIONS

Factory laminated homogenous vinyl tile with monolithic edge

- ☐ .080" Tarkett IQ Optima Homogenous Vinyl
- ☐ .080" Tarkett IQ Granit Homogenous Vinyl

- Tile Color \_\_\_\_\_

### Laminated Panel With Monolithic Edge

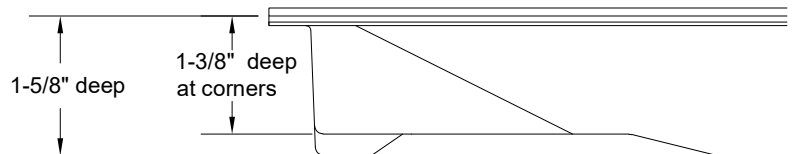

### System Performance Criteria (Tested on Actual Understructure)

System Type		SYSTEM WEIGHT	STATIC LOADS			ROLLING LOADS		IMPACT LOADS
Panel	Understructure		Design Loads	Ultimate Loads	Safety Factor	10 Passes	10,000 Passes	
ConCore 2500/3000 -24" Bare	4' x .054" Bolted Stringer	13.0 lbs / ft <sup>2</sup> 63.5 kg / m <sup>2</sup>	2500 lbs 1134 kg	Min. 5000lbs Min. 2268kg	Min. 2	2000 lbs 907 kg	2000 lbs 907 kg	200 lbs 91 kg
ConCore 2500/3000 -24" Bare	2" Deep Bolted Stringer	13.5 lbs / ft <sup>2</sup> 65.9 kg / m <sup>2</sup>	3000 lbs 1361 kg	Min. 6000lbs Min. 2722kg	Min. 2	2700 lbs 1225 kg	2400 lbs 1089 kg	300 lbs 136 kg

COVERING	TILE WEIGHT	STATIC LOAD PERFORMANCE <sup>3</sup>
Homogenous Vinyl (Tile only)	0.63 lbs / ft <sup>2</sup> 3.1 kg / m <sup>2</sup>	250 lbs 113 kg

1. System Design Load is based on permanent set  $\leq 0.010"$  and is verified by loading panels in accordance with the CISC concentrated load method but with panels installed on actual understructure instead of steel blocks. (Testing on blocks does not represent performance of an actual installation.) Ultimate, Rolling, and Impact Load tests are performed using CISC test procedures.

2. Safety Factor is Ultimate Load divided by Design Load.

3. Most resilient tiles manufacturers rate their tiles per ASTM F970 which requires a minimum 250 psi static load performance, however some tiles may exceed this minimum requirement. Contact tile manufacturer for more information.



Tate reserves the right to amend product information without prior notice. Care has been taken to ensure that the contents of this publication are accurate, but Tate, its parent company and its subsidiary companies do not accept responsibility for errors or information that is found to be misleading or outdated. Suggestions for, or descriptions of, technical specifications and the end user or application of products are provided and must be verified prior to use. To ensure you are viewing the most recent and accurate product information, please scan the QR code.