

TOP VIEW

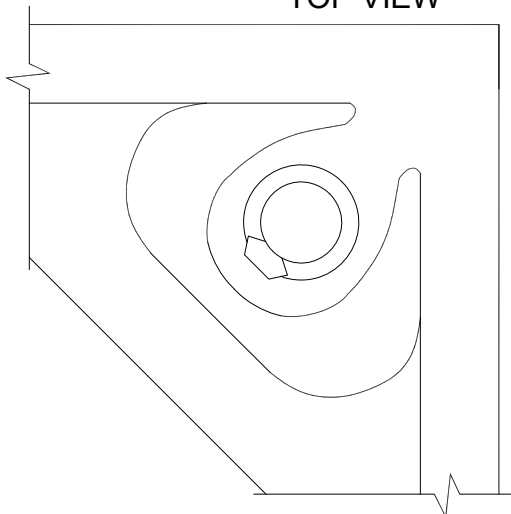

CORNER DETAIL

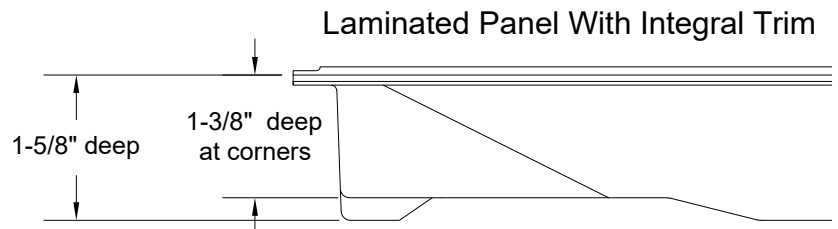

SPECIFICATIONS

General information (Bare Panel)

- All steel welded construction filled internally with a cementitious core material.
- Protected from corrosion by an epoxy paint finish.
- Class A flame spread rating.

UNDERSTRUCTURE OPTIONS

- ☐ 4' Bolted Stringer
- ☐ 4' Box Stringer

COVERING OPTIONS

Tile factory laminated with integral trim edge

- ☐ 1/16" HPL _____ (Color) _____

System Performance Criteria (Tested on Actual Understructure)

System Type		SYSTEM WEIGHT	STATIC LOADS			ROLLING LOADS		IMPACT LOADS
Panel	Understructure		Design Loads	Ultimate Loads	Safety Factor	10 Passes	10,000 Passes	
ConCore 1250-24" Bare	4' Bolted Stringer	8.5 lbs / ft ² 41 kg / m ²	1250 lbs 567 kg	Min. 2500lbs Min. 1134kg	Min. 2	1000 lbs 454 kg	800 lbs 363 kg	150 lbs 68 kg
	4' Box Stringer	9.5 lbs / ft ² 46.38 kg / m ²	1250 lbs 567 kg	Min. 2500lbs Min. 1134kg	Min. 2	1000 lbs 454 kg	800 lbs 363 kg	150 lbs 68 kg

COVERING	TILE WEIGHT	PERFORMANCE ³
High Pressure Laminate (Tile only)	0.38 lbs / ft ² 1.83 kg / m ²	Based on NEMA LD 3 Standard for High Pressure Laminate

1. System Design Load is based on permanent set $\leq 0.010"$ and is verified by loading panels in accordance with the CISC concentrated load method but with panels installed on actual understructure instead of steel blocks. (Testing on blocks does not represent performance of an actual installation.) Ultimate, Rolling, and Impact Load tests are performed using CISC test procedures.

2. Safety Factor is Ultimate Load divided by Design Load.

3. High Pressure Laminate Manufacturers rate their tile's performance based on NEMA LD 3 standard for High Pressure Laminate. Contact tile manufacturer for more information.

4. Published load ratings do not apply to perimeter, cut panels or panels with cutouts



Tate reserves the right to amend product information without prior notice. Care has been taken to ensure that the contents of this publication are accurate, but Tate, its parent company and its subsidiary companies do not accept responsibility for errors or information that is found to be misleading or outdated. Suggestions for, or descriptions of, technical specifications and the end user or application of products are provided and must be verified prior to use. To ensure you are viewing the most recent and accurate product information, please scan the QR code.